

Android VPN Setup Guide

Summary

Overall, there are two steps needed to make Android built-in VPN client work with VPN server (*IPsec Service Provider* model) made by *vpneveryone.ddns.net*

1. Install certificates exported from VPN server to Android device.
2. Configure Android VPN type to *"IKEv2/IPSec RSA"*.

Step 1, Install Certificates

You should have received a certificate package with file name in such format *YYYYMMDDhhmmss-xxxxd-username.p12* , e.g. *20240929021335-180d-pixel6a.p12*

The instructions & screenshots below are based on *"Google Pixel 6a with Android version 14"*. Setup on your version Android may vary.

1. Find a way to transfer this file to your Android device. E.g. email attachment, microSD card, attach to PC by USB, or google drive, etc.
2. On your Android device, tap the *"Setting"* app, and then follow the menu path: *"Security & privacy"* → *"More security & privacy"* → *"Encryption & credentials"* → *"Install a certificate"* → *"VPN & app user certificate"* → select the *.p12* file you transferred to in your Android device at step 1 above.
3. When asked for *"Type the password to extract the certificates"*, use the username part of the *.p12* file name, e.g. if you *20240929021335-180d-pixel6a.p12* from your VPN service provider, use *pixel6a* as password.
4. In next screen *"Name this certificate"*, just tap OK to use the default name. That finishes importing the certificate.

Below are the screenshots for the steps above.

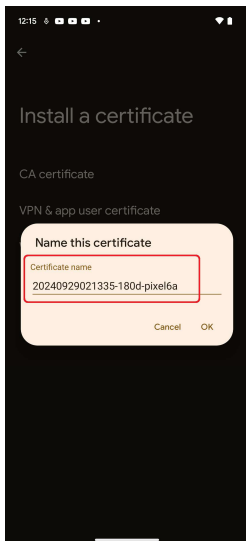
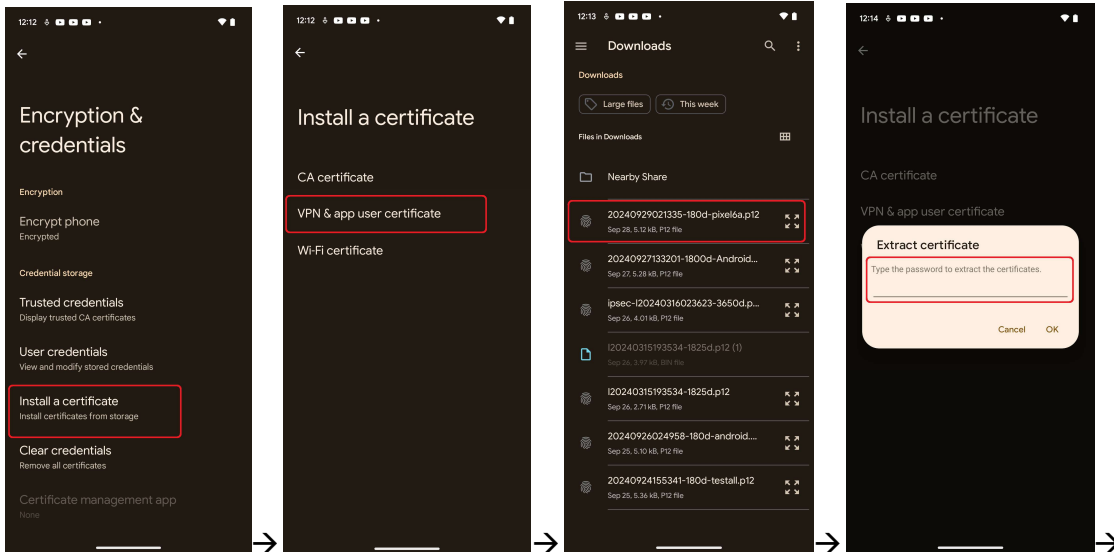
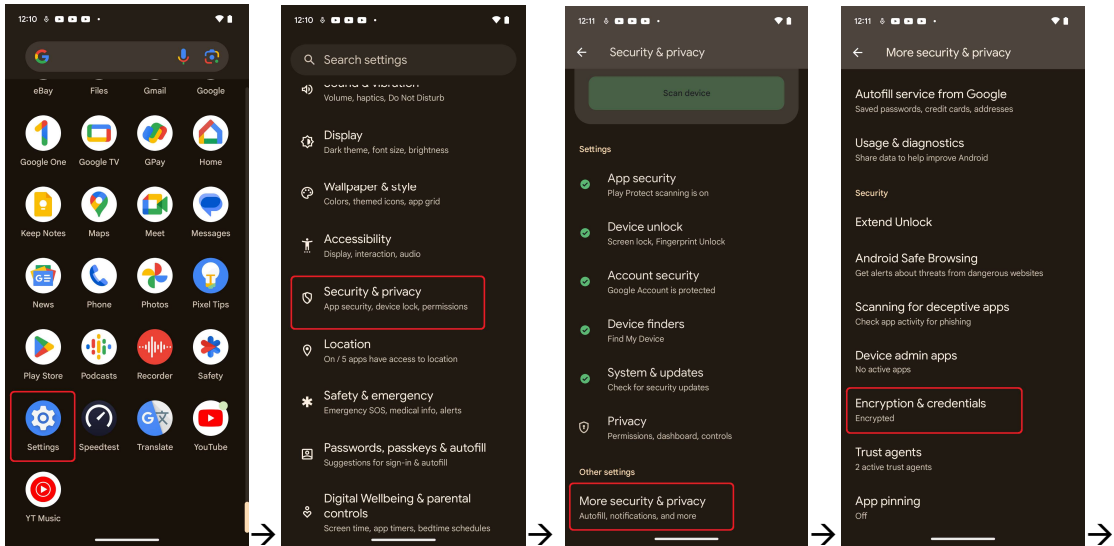

Step 2, Configure Android VPN Client

You don't need to install any VPN app to run this VPN service. This is especially useful for users in countries where their local governments block the Google Play Store, or limit downloading VPN apps.

1. On your Android device, tap the **"Setting"** app, and then follow the menu path: **"Network & internet"** → **"VPN"** → **"+"** →
 - Fill in any string you like for **"Name"** field. E.g. **"Manual Demo"**
 - Select **"IKEv2/IPSec RSA"** for **"Type"**.
 - Ask your VPN service provider for the **"Server address"** and fill it in here.
 - Select the certificate you installed in earlier section **"Step 1, Install Certificates"** for **"IPSec user certificate"** e.g. **20240929021335-180d-pixel6a.p12**
 - Select the certificate you installed in earlier section **"Step 1, Install Certificates"** for **"IPSec CA certificate"**. (**Not a typo**, the certificate package installed in step 1 contains user certificate and CA certificate)
 - Type in **"IPSec identifier"** field, the certificate name without .p12 part. (**Note**: Older version Android does **not** have this field, e.g. Android version 8.0.0)
 - Use the default option **"Received from server"** for **"IPSec server certificate"**
 - Tap **"Save"** to finish setting up Android VPN client.
 - Tap the VPN connection just configured and then tap **"Connect"** to connect to VPN server.

Below are the screenshots for the steps above. They are based on **"Google Pixel 6a with Android version 14"**. Setup on your version Android may vary.

